

DESCRIPTION

Based on the Aluminum Honeycomb technology, the AFL FULLWIDTH barrier face is mainly used to evaluate restraint system tests and car-to-car accident analysis (compatibility).

For the full overlap test procedure, the current objective is to provide a high acceleration pulse and to have to look at car's structural interaction for compatibility assessments of cars.

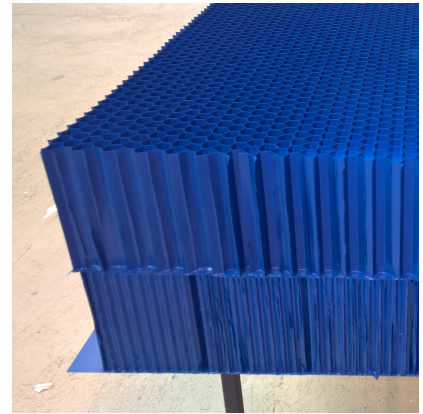

CERTIFICATION

The AFL FULLIDTH barrier is manufactured according to the TRL technical specifications

A complete testing procedure for certification of aluminum honeycomb is performed in-house for each barrier face manufacture.

DELIVERY

- Permanent stock available
- Standard Shipment is 2/3 weeks from order within European Union.
- Blue anti reflective paint as standard, customized painting on demand

PACKAGING

- Individual cardboard crate
- External dimensions: 2150 x 1250 x 510 mm
- Weight: 40 to 42 kg

QUALITY ASSURANCE

AFL Honeycomb Structures products are designed and manufactured according to the ISO 9001 (V2015) standard



TECHNICAL PROPERTIES

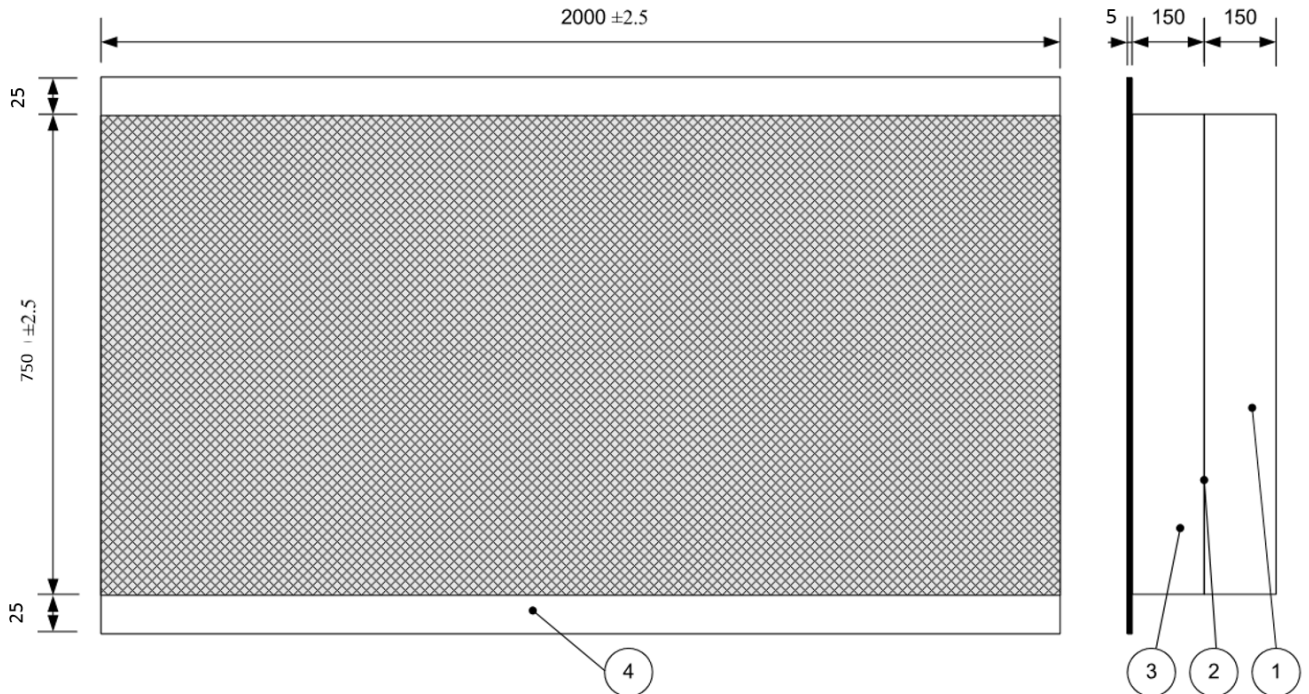

www.afl-crashtestbarriers.com

1. Frontal Honeycomb deformable core

- Height: 750±2.5 mm
- Width: 2000±2.5 mm
- Deep: 150±2.5mm
- Material: Aluminum 3003
- Foil Thickness: 0.076mm±15%
- Cell Size: 19.1mm±20%
- Density: 28.6kg/m³±20%
- Crush Strength: 0.342MPa+0%-10%

2. Intermediate Plate

- Fiber glass

3. Rear honeycomb deformable core

- Height : 750±2.5 mm
- Width : 2000±2.5 mm
- Deep : 150±2.5mm

- Material: Aluminum 3003
- Foil Thickness: 0.076mm±15%
- Cell Size: 6.4mm±20%
- Density: 82.6kg/m³±20%
- Crush Strength: 1.711MPa+0%-10%

4. Backing Sheet

- Height: 800±2.5 mm
- Width: 2000±2.5 mm
- Thickness: 5.0±0.1mm
- Material: Aluminum 5052

5. Adhesive:

- Two-part polyurethane/resin with hardener